

C2 Series Metric Nitrile Piston U-Cups

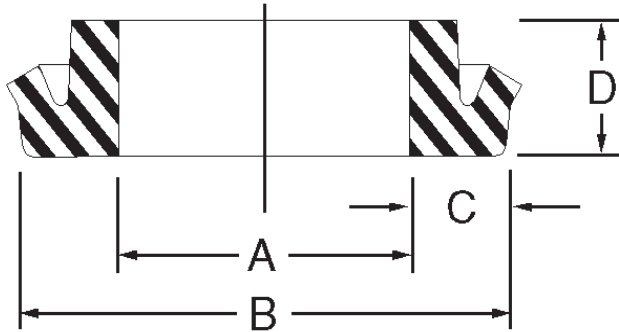

C2 style piston seals have excellent sealing performance despite the small profile. Extremely low friction is experienced because of the short contact area at the sealing surface. These piston seals are manufactured undersized on the internal diameters in relation to the nominal dimensions. This ensures the required tight fit and eliminates heel drag on the dynamic surface. Only after installation will the sealing lip diameter show the desired dimensions. Profile C2 piston seals stretch easily into the groove of one piece pistons. Standard material is 84 durometer nitrile, and may be used at a temperature range of -65 to +220 degrees F in hydraulic applications and -65 to +180 degrees F in pneumatic applications. Maximum working pressure for hydraulic use is 2350 psi and for pneumatic use is 235 psi.

Temperature: -65F to 220F(see above)

Pressure: 0 to 2350 psi (see above)

Part Number					Price
Prefix	Inside Dia. A mm	Outside Dia. B mm	Height D mm		
C2 -	6	X 12	X 4		
C2 -	8	X 12	X 3		
C2 -	8	X 14	X 4		
C2 -	8	X 16	X 5.5		
C2 -	10	X 16	X 4		
C2 -	10	X 18	X 5.5		
C2 -	12	X 20	X 5.5		C
C2 -	14	X 20	X 4.2		A
C2 -	14	X 22	X 5.5		L
C2 -	16	X 24	X 5.5		L
C2 -	17	X 25	X 5.5		
C2 -	18	X 26	X 5.5		F
C2 -	18	X 28	X 8		O
C2 -	20	X 28	X 5.5		R
C2 -	20	X 30	X 7		
C2 -	22	X 30	X 5.5		P
C2 -	22	X 32	X 7		R
C2 -	24	X 32	X 5.5		I
C2 -	25	X 35	X 7		C
C2 -	26	X 36	X 7		E
C2 -	28	X 38	X 7		
C2 -	30	X 40	X 7		
C2 -	32	X 40	X 5.5		
C2 -	35	X 45	X 7		
C2 -	40	X 48	X 5.5		
C2 -	40	X 50	X 7		
C2 -	42	X 50	X 8		

Part Number					Price
Prefix	Inside Dia. A mm	Outside Dia. B mm	Height D mm		
C2 -	45	X 55	X 7		
C2 -	48	X 60	X 7.5		
C2 -	50	X 60	X 7		
C2 -	53	X 63	X 7		
C2 -	53	X 65	X 10		
C2 -	55	X 65	X 7		
C2 -	57	X 67	X 7		C
C2 -	58	X 68	X 7		A
C2 -	58	X 70	X 8.5		L
C2 -	68	X 80	X 8.5		L
C2 -	73	X 85	X 8.5		
C2 -	78	X 90	X 8.5		F
C2 -	88	X 100	X 8.5		O
C2 -	95	X 110	X 10		R
C2 -	110	X 125	X 10		
C2 -	115	X 130	X 10		P
C2 -	115	X 135	X 14		R
C2 -	120	X 140	X 14		I
C2 -	125	X 140	X 10		C
C2 -	135	X 150	X 10		E
C2 -	140	X 160	X 14		
C2 -	145	X 160	X 10		
C2 -	160	X 180	X 14		
C2 -	180	X 200	X 14		
C2 -	200	X 220	X 14		
C2 -	230	X 250	X 14		